

Port denomination of a SWEP BPHE



SWEP is the world's leading supplier of compact brazed plate heat exchangers (BPHEs). These products are used where heat needs to be transferred efficiently in air conditioning, refrigeration, heating, and industrial applications. SWEP is close to its customers, with representation in more than 50 countries and its own dedicated sales force in more than 20 countries. Highly efficient production units in Sweden, Switzerland, the USA, Malaysia, Slovakia, and China enable SWEP to serve customers all over the world. SWEP is part of the global Dover Corporation, which is a multi-billion-dollar, NYSE-traded, diversified manufacturer of a wide range of proprietary products and components for industrial and commercial use.



SWEP International AB  
 Box 105, SE-261 22 Landskrona, Sweden  
 Tel. +46 418 40 04 00. Fax +46 418 292 95  
 Internet: [www.swep.net](http://www.swep.net)  
 E-mail: [info@swep.net](mailto:info@swep.net)

Printed on 100% recycled paper. SWEP is an ISO 14001 Certified company.

# DOUBLE WALL – INCREASED EFFICIENCY AND SAFETY



CHALLENGE EFFICIENCY



## SWEP Double Wall – increased efficiency and safety

SWEP double-wall, high-quality products combine high efficiency with double-wall technology while keeping the advantages of the brazed plate heat exchanger – including compactness. These products are dedicated to applications where the fluids must not mix, such as heat pump applications, boilers, transformer oil cooling, de-super heaters, and heat recovery from air compressors.



## High-quality products

SWEP's Double Wall range is produced in a unique way with full control of the process. At SWEP, quality and safety are high priorities, and all products are individually pressure- and leak-tested for safe operation and long lifespan.



## SWEP double wall technology

SWEP's Double Wall technology ensures that liquids do not mix and makes any internal leaks visible – important factors in applications where safety is a priority.

- Internal leakage can be detected
- Exceptional double-wall thermal efficiency

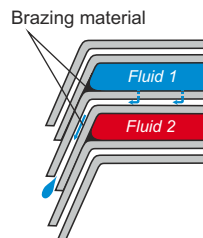

## B16DW

The B16DW is our optimized product for medium capacities, targeting heat recovery and tap water heating.

### Pressure classes

- S** Standard, evaluated per EN 13345 (25-38 bar/363-550 PSI).
- M** Medium, evaluated per EN 13345 (38-48 bar/550-696 PSI).
- H** High, evaluated per EN 13345 (42-56 bar/609-812 PSI).

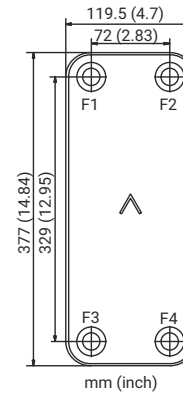
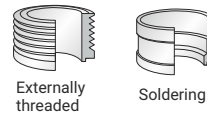

|                            |                                 |
|----------------------------|---------------------------------|
| Max number of plates (NoP) | 140                             |
| Port size F1/P1            | 27 mm (1.063 in)                |
| Port size F2/P2            | 27 mm (1.063 in)                |
| Port size F3/P3            | 27 mm (1.063 in)                |
| Port size F4/P4            | 27 mm (1.063 in)                |
| Max volume flow            | 11 m <sup>3</sup> /h (48.4 gpm) |

| Materials | Channel plate   | Brazing |
|-----------|-----------------|---------|
| SC        | Stainless steel | Copper  |

| Size | Height of plate pack | Total weight        |
|------|----------------------|---------------------|
| SC S | 4+(2×NoP) mm         | 1.55+(0.22×NoP) kg  |
| SC M |                      |                     |
| SC H | 0.157+(0.079×NoP) in | 3.42+(0.485×NoP) lb |

## B35TDW

The B35TDW targets applications in the higher capacity ranges, focusing on de-super heaters, boilers, transformer oil cooling, and heat recovery from air compressors.

### Pressure classes

- H** High, evaluated per EN 13345 (47 bar at 135°C 682 PSI at 275°F).

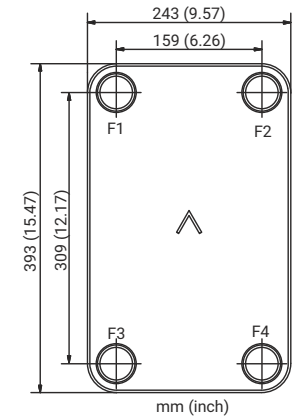
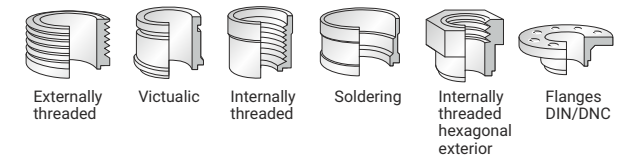

|                            |                                  |
|----------------------------|----------------------------------|
| Max number of plates (NoP) | 260                              |
| Port size F1/P1            | 61 mm (2.402 in)                 |
| Port size F2/P2            | 61 mm (2.402 in)                 |
| Port size F3/P3            | 61 mm (2.402 in)                 |
| Port size F4/P4            | 61 mm (2.402 in)                 |
| Max volume flow            | 58 m <sup>3</sup> /h (255.2 gpm) |

| Materials | Channel plate   | Brazing |
|-----------|-----------------|---------|
| SC        | Stainless steel | Copper  |

| Size | Height of plate pack | Total weight        |
|------|----------------------|---------------------|
| SC H | 18+(2.53×NoP) mm     | 12.3+(0.494×NoP) kg |
|      | 0.709+(0.1×NoP) in   | 27.11+(1.09×NoP) lb |