

HVAC Insulation

This product sheet describes our HVAC insulation boxes for heating applications.

SWEP accessories meet the same high standards as the company's BPHEs. They are produced according to SWEP's specification by rigorously selected suppliers. The high-quality materials are carefully chosen for compatibility, while the accurate dimensions save you time and money on installation. With SWEP accessories you have the assurance that everything will fit and perform the way the design engineers intended.

For more information, please contact your local SWEP representative.

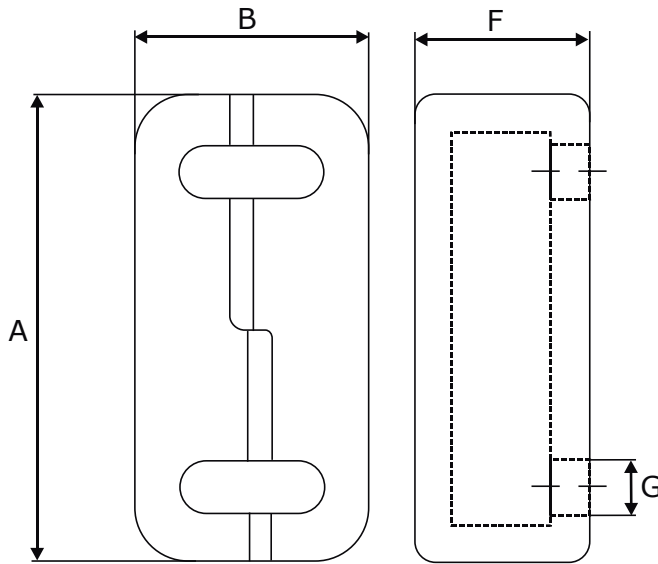

Technical data	
Max operating temperature	130°C
Color	Red
Thermal conductivity	0.032 W/mK
Fire properties	B2 in accordance with DIN4102 T2
Insulation material	Rigid expanded polyurethane
Cover material	Polystyrene 475K

Size	5T	8T	10T/12	15	16/26	25T/28/80
A (in)	9.68	15.2	14.02	20.87	17.8	23.39
B (in)	4.69	5	7.13	4.96	7.28	7.17
F (in)* approx.	$2.6+0.087 \times \text{NoP}$	$3.03+0.088 \times \text{NoP}$	$2.83+0.088 \times \text{NoP}$	$2.6+0.098 \times \text{NoP}$	$3.35+0.088 \times \text{NoP}$	$3.32+0.094 \times \text{NoP}$
G (in)	1.38	1.38	1.97	1.38	1.77	1.97
Thickness (in)	0.79	0.98	1.18	0.98	0.98	1.18
Weight (lb)	0.7	$0.015 \times \text{NoP} + 0.7$	$0.02 \times \text{NoP} + 0.9$	$0.03 \times \text{NoP} + 0.8$	$0.02 \times \text{NoP} + 1$	$0.06 \times \text{NoP} + 9.7$

*Only available in selected 10th NoP (for example 10, 20, 30, etc). NoP = Number of Plates

Size	35	50/56/120T/200T	65	427
A (in)	19.49	24.69	42.24	33.46
B (in)	13	13	19.69	16.46
F (in)* approx.	$4.14+0.094 \times \text{NoP}$	$4.14+0.094 \times \text{NoP}$	$7.0+0.094 \times \text{NoP}$	$6.08+0.091 \times \text{NoP}$
G (in)	2.67	3.35	4.84	6.81
Thickness (in)	1.57	1.57	2.36	2.36
Weight (lb)	$0.03 \times \text{NoP} + 1.5$	$0.03 \times \text{NoP} + 2.6$	$0.05 \times \text{NoP} + 2.3$	$0.17 \times \text{NoP} + 8.8$

*Only available in selected 10th NoP (for example 10, 20, 30, etc). NoP = Number of Plates

www.swep.net



A DOVER COMPANY